



- 4,237 Total Sq./Ft. • 708 Sq./Ft. Bonus Room
- 3 Bedrooms • 2.5 Bathrooms • 1.5 Story
- Stone fireplace in great room and hearth room
- Master bedroom suite with gas log fireplace
- Dual sinks, tiled shower and soaking tub in master bathroom • Office and music room
- Custom cabinetry with quartz countertops
- Laundry room with crafting studio • Four stall garage • Vaulted ceilings • Barn doors

## FIRST FLOOR PLAN

3,400 Sq./Ft. - NOT TO SCALE



## SECOND FLOOR PLAN

837 Sq./Ft. - Not NOT TO SCALE

708 Sq./Ft. Bonus Room

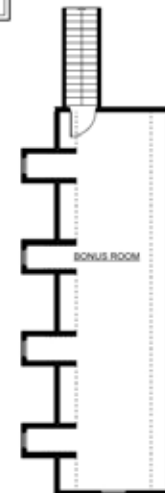

*The "October 2017"  
home plan is copyrighted  
to PortSide Builders, Inc.*